

DATE REVISED	DATE FILMED	DATE REVISED	DATE FILMED	FED. ROAD DIST. NO.	STATE	FED. AID PROJ. NO.	SHEET NO.	TOTAL SHEETS
06/03/10 10/14/11				6	ARK.			
				JOB NO.		110394	45	196
				06830	LAYOUT		41957	

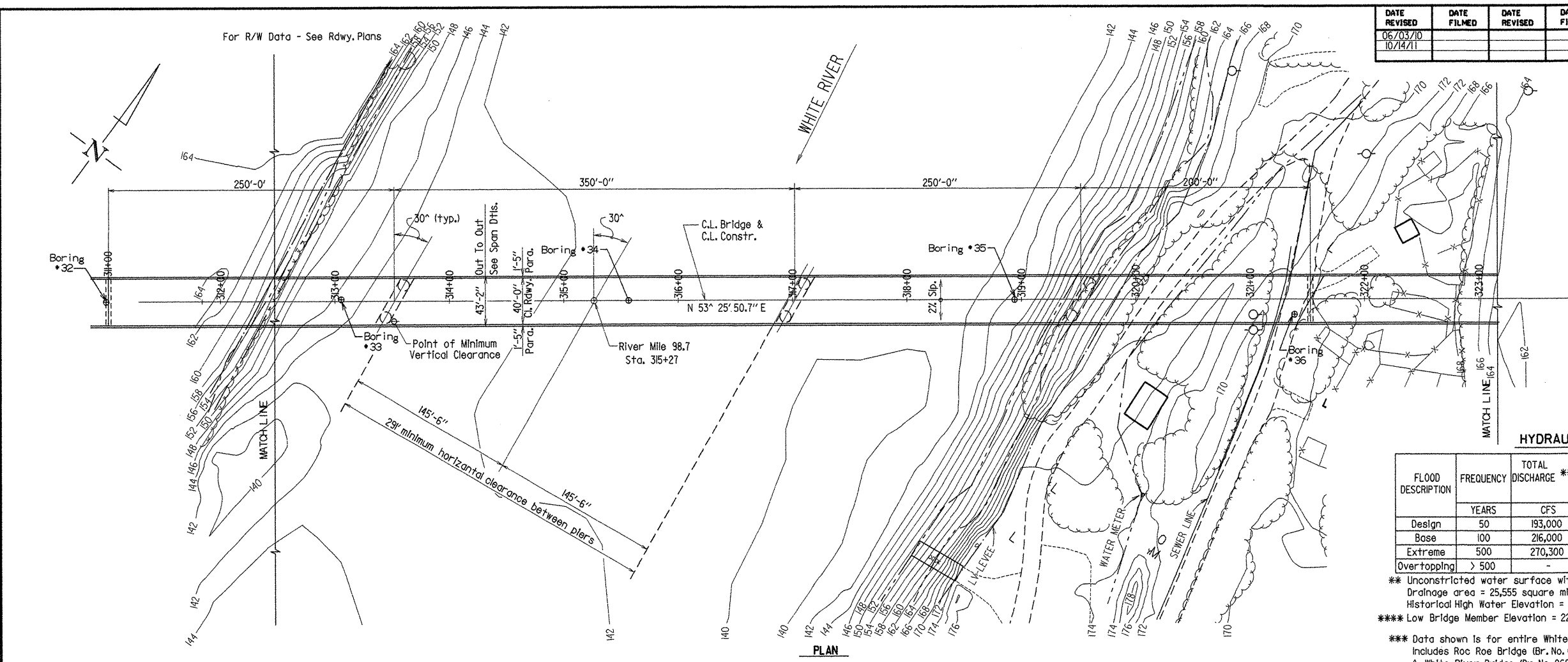

HYDRAULIC DATA

FLOOD DESCRIPTION	FREQUENCY YEARS	TOTAL DISCHARGE *** CFS	DISCHARGE THRU BRIDGE CFS	**NATURAL WATER SURFACE ELEVATION FEET	WATER SURFACE ELEV. WITH BACKWATER FEET
Design	50	193,000	139,000	174.0	174.9
Base	100	216,000	155,600	175.5	176.0
Extreme	500	270,300	194,600	177.4	177.7
Overtopping	> 500	-	-	-	-

*** Unconstricted water surface without structure or roadway approaches.
 Drainage area = 25,555 square miles.
 Historical High Water Elevation = 174.9 (1973)
 **** Low Bridge Member Elevation = 223.6
 *** Data shown is for entire White River Floodplain.
 Includes Roc Roe Bridge (Br. No. 06829), White River Relief Bridge (Br. No. 07027), & White River Bridge (Br. No. 06830)

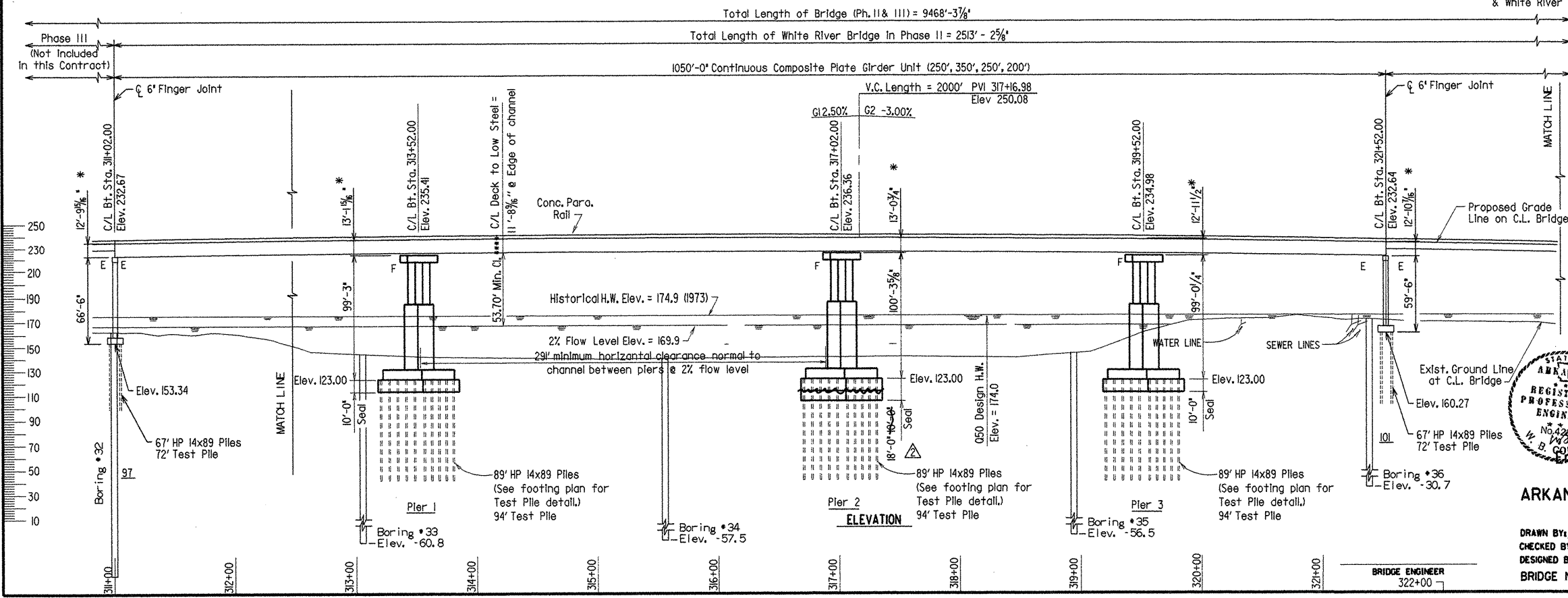

*Top of Deck at C.L. Bridge and C.L. Bent to Low End of Cap
 Strip Seal Joints are designated as 'X' Strip Seal Joints where 'X' represents the 'A' dimension at 60 degrees F as shown in the table on dwg. nos. 42008-42011.
 Note: See dwgs. no. 41961 - 41962 for Soil Borings & additional data.
 See dwg. no. 41960 for General Notes.

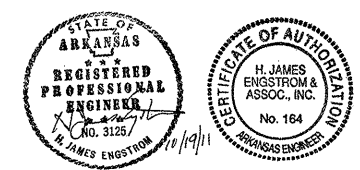

REVISD AND REDRAWN By AHTD
 06/03/10 MJT CHECKED BY: HJE/MM
 REVISD PIER 2 SEAL DEPTH BY HJE/MM
 GPT 10/14/11 PER CHANGE ORDER NO. 9

ALTERNATE NO. 1
ABANDONMENT OF BRIDGE OVER WHITE RIVER
 (SHEET 2 OF 4)
 WHITE RIVER STR. & APPRS.
 (CLARENDON) (PH. II) (F)
 MONROE COUNTY
 Engstrom / Modjeski and Masters
 ROUTE 79 SEC. 13
 ARKANSAS STATE HIGHWAY COMMISSION
 LITTLE ROCK, ARK.

DRAWN BY: LKD/TAD DATE: Feb. 06 FILENAME: b110394112rev1
 CHECKED BY: YO DATE: Feb. 06 SCALE: 1" = 50'-0"
 DESIGNED BY: YO DATE: Feb. 06
 BRIDGE NO. 06830 DRAWING NO. 41957